

# RAM® Tele-Pole™ Assembly Instructions

Pat. Pend.

## Parts Index

- A. 3/8" DIA. HEX BOLT
- B. NYLON WASHER
- C. 3/8" ID X 1 1/4" OD WASHER
- D. THRUST WASHER (SEE DETAIL AA)
- E. 2 1/2"DIA. PLASTIC KNOB
- F. THREADED ROD
- G. WEDGE CASTING
- H. SPRING
- J. 3/8" HEX NYLOCK NUT
- K. UPPER TUBE

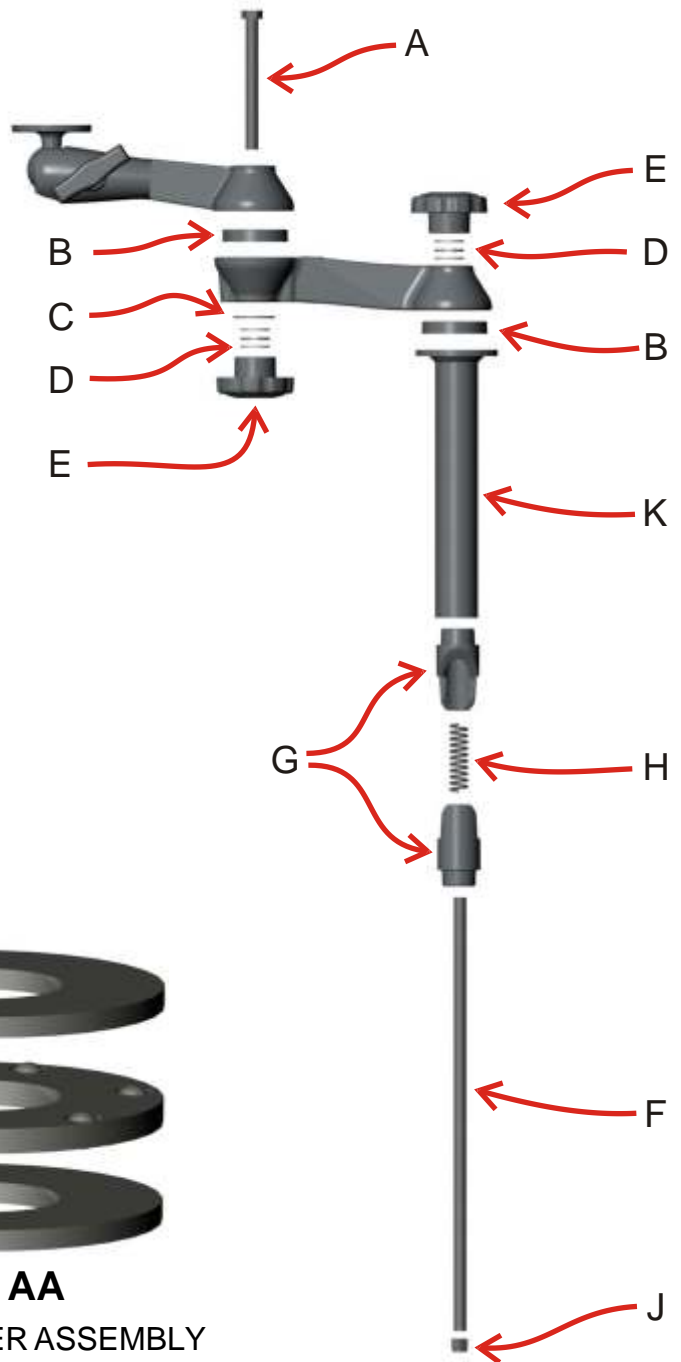

3/8" ID X .80" OD STEEL WASHER



3/8" ID BALL BEARING WASHER



3/8" ID X .80" OD STEEL WASHER



### Detail AA

THRUST WASHER ASSEMBLY

National Products, Inc.  
Phone: 206-763-8361  
Fax: 206-763-9615  
Address: 1205 S Orr St  
Seattle, WA 98108  
Website: [www.ram-mount.com](http://www.ram-mount.com)  
Email: [staff@ram-mount.com](mailto:staff@ram-mount.com)

